

# DINITROL PRODUCTS

---

## GLASS REPLACEMENT



CAR AFTERMARKET





# DIRECT GLAZING

## The complete Vehicle Glass Replacement system

### START REMOVING THE WINDSCREEN

Follow the car manufacturer's instructions to remove the windscreen

#### 1 CLEANING

Clean the windscreen with DINITROL 7250 and the area to be bonded with DINITROL 582 – apply using a clean cloth, (approx. 1 minute).



#### 2 FIRST ALTERNATIVE

##### ⇒ ACTIVATING AND PRIMING

Wipe on – using a clean cloth, apply DINITROL 520 to the back ceramic border of the windscreen. Wipe off with a fresh cloth after DINITROL 520 has evaporated (approx. 1 minute). Shake the DINITROL 530 can vigorously for at least one minute after loosening the steel ball. Apply DINITROL 530 onto the activated ceramic border with long even strokes. For best results use a woollen wiper. The drying time is 10 minutes. Paint scratches on the flange should be covered with DINITROL 530 for corrosion prevention.



#### SECOND ALTERNATIVE

##### ⇒ 1-STEP-PRIMING

Shake the DINITROL 538 plus can vigorously for at least one minute after loosening the steel ball. Apply DINITROL 538 plus onto the ceramic border with long even strokes. For best results use a woollen wiper. The drying time is 10 minutes. Paint scratches on the flange should be covered with DINITROL 538 plus for corrosion prevention.



#### PUR-RIM

Some vehicle windscreens are pre-treated with polyurethane. The PUR on these screens must be activated with DINITROL 540 apply on to the surface with a woollen wiper and let it dry for at least 10 minutes. No further treatment is necessary. The DINITROL polyurethane adhesive can be applied after that the DINITROL 540 has dried.



#### 3 APPLYING ADHESIVE

Existing polyurethane bead must be trimmed to a thickness of 1-2 mm. Freshly cut PUR bead is an excellent base for the polyurethane adhesive. Select the DINITROL polyurethane adhesive that best suits your needs. Apply adhesive to the edge of the glass or flange. Glass must be pre-treated in accordance with the instructions above.



### FINISH FITTING THE WINDSCREEN

The windscreen must be fitted before a skin forms on the polyurethane bead. Temperature and relative humidity should be measured and the Safe Drive Away Time established!

#### HANDLING PRECAUTIONS

DINITROL polyurethane products contain isocyanates. Please read the material safety data sheets and the following user instruction;

- Work in well ventilated areas
- Avoid contact with skin and eyes
- Wear protective gloves and glasses
- The pre-treatment products are highly flammable
- Keep away from sources of ignition, sparks and fire



# DINITROL PRODUCTS GLASS REPLACEMENT

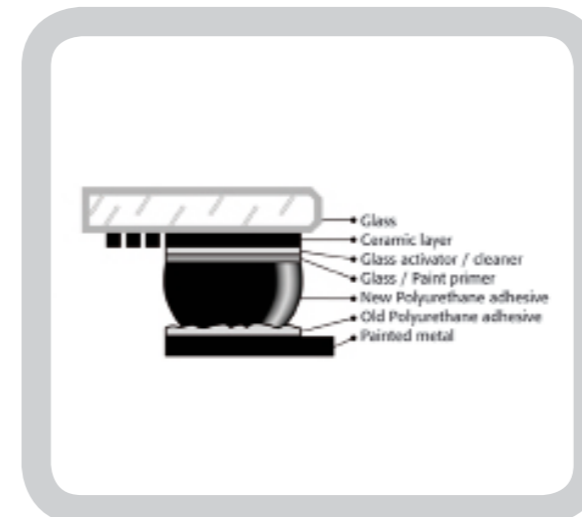
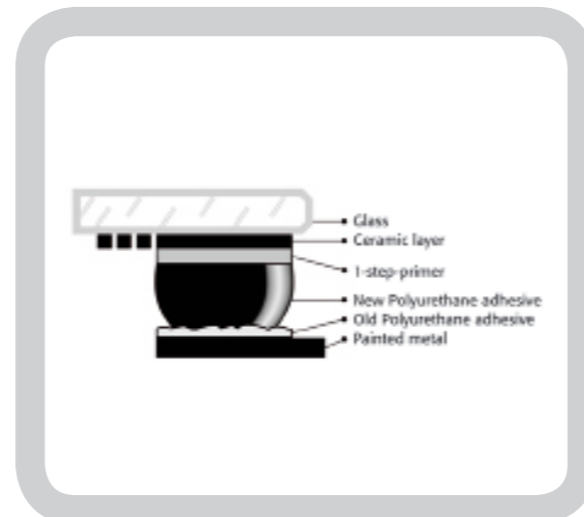
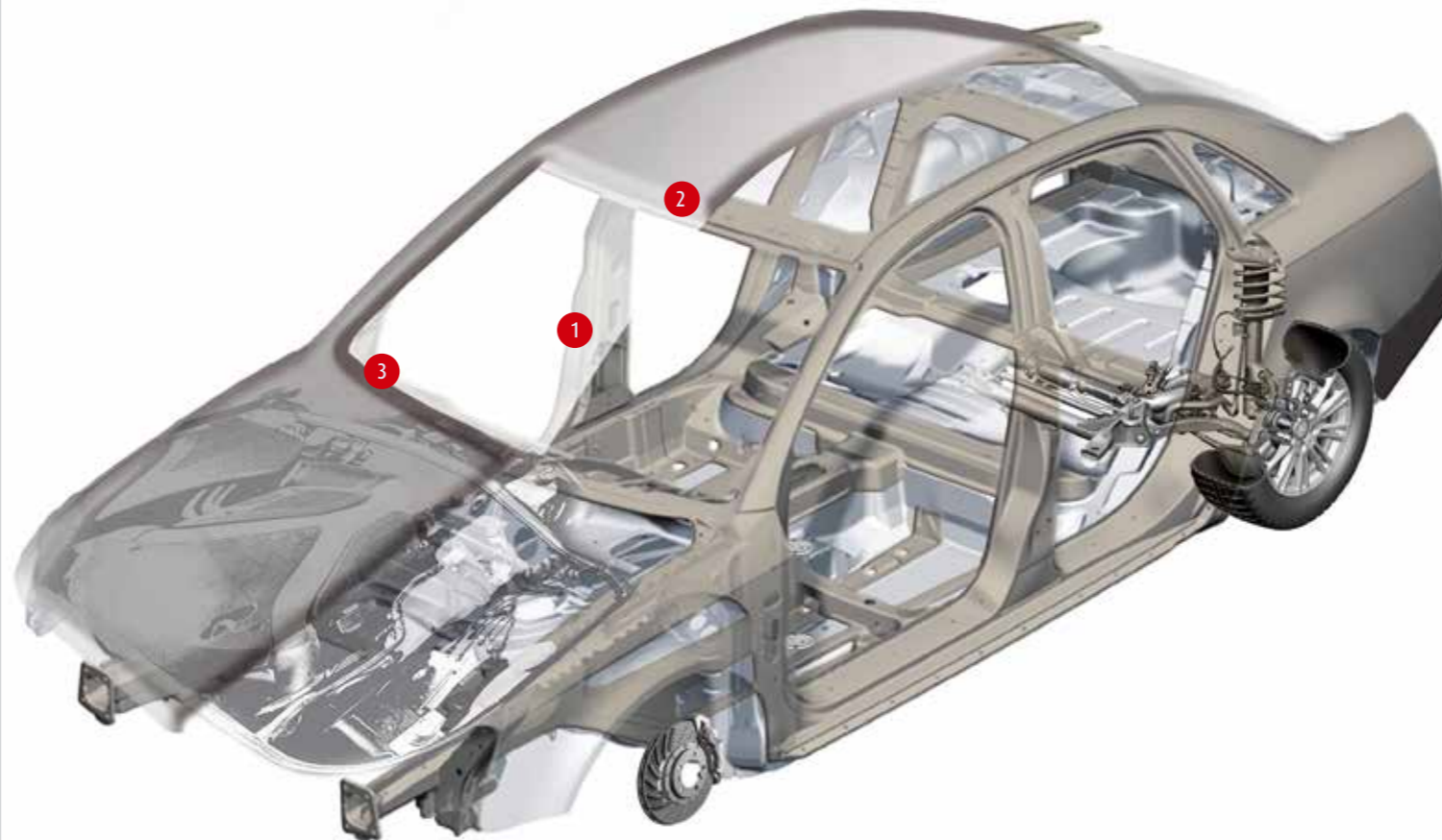

#### 1 Glass Cleaner

DINITROL 7250

clear



#### Special Cleaner

DINITROL 582

clear

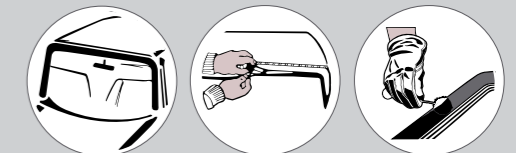

#### 2 Pretreatment

##### Activating & Priming

DINITROL 520

clear

DINITROL 530

black

##### One-Step Priming

DINITROL 538 Plus

black

##### Activating

DINITROL Activator plus

clear

##### Activating PUR - RIM

DINITROL 540

clear



#### 3 Adhesives

DINITROL 9100

black

1/2 h

DINITROL 9000

black

3/4 h

DINITROL 501 FC-HM

black

1 h

DINITROL 500

black

2 h

Safe Drive  
Away Times

Technical data sheets and instruction issued by the product manufacture must be strictly observed.

